

PORTA ROMANA



Rupi Ceramic Wall Light Large

TWL168L | Myrtle

Myrtle

HEIGHT
480mm | 18 ¾"

CONSTRUCTED FROM
Glazed ceramic

WATTAGE
3W

WIDTH
390mm | 15 ¼"

WEIGHT
2.5kg | 5 ¾ lbs

LAMPING
3 x 75lm (1w) LED Module Supplied Fitted

PROJECTION
100mm | 4"

MATERIAL
Glazed ceramic

VOLTAGE
120V

DESIGNERS NOTE
This product requires a wall cavity

FINISHES
Almond
Myrtle
Pudding
Tigers Eye



Wall Fixing

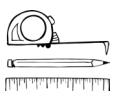

Custom

Rupi Ceramic Wall Light Large

TWL168L

HEIGHT
480mm | 18 3/4"

WIDTH
390mm | 15 1/4"

PROJECTION
100mm | 4"

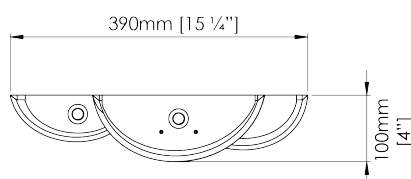
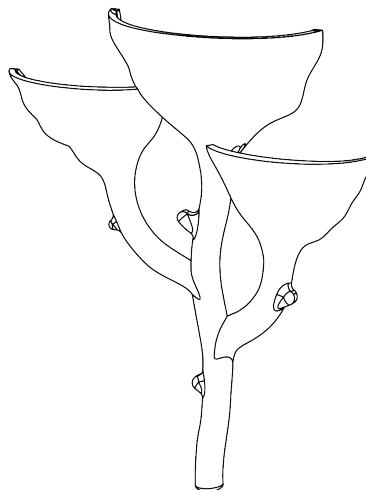

TOP VIEW

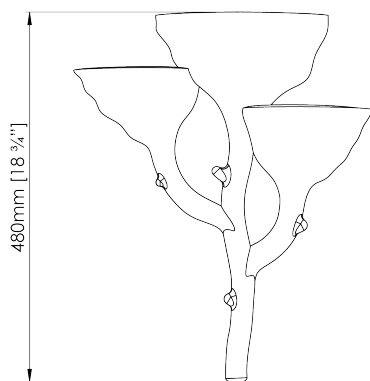

FRONT VIEW

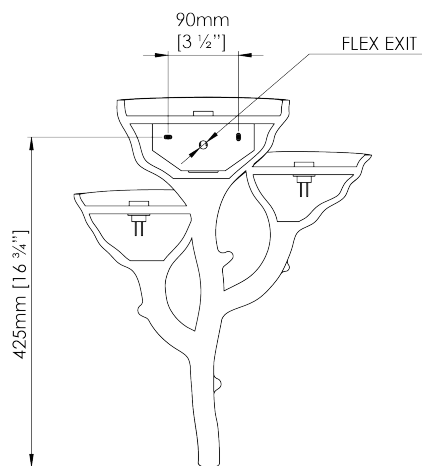

REAR VIEW

© Porta Romana 2025

Dimensions and weights are provided as a guide. All Porta Romana Products are made by hand and variations can occur in some products. The products you are buying or marketing are exclusive designs belonging to Porta Romana. Please do not submit design sheets featuring our products to other manufacturing companies nor to other parties who might. Any manufacturer found to be reproducing Porta Romana products will be breaching copyright law and will be actively pursued